

Aesthetic Congress Communications

THE INTERNATIONAL CONGRESS OF ESTHETICS AND SPA | MIAMI, FL

Hyatt Regency / James L. Knight Center | Nov 6 & 7, 2016

les nouvelles
esthétique & spa
AMERICAN EDITION

DERMASCOPE
The Encyclopedia of Aesthetics

FLOOR PLAN

1 UPPER LEVEL

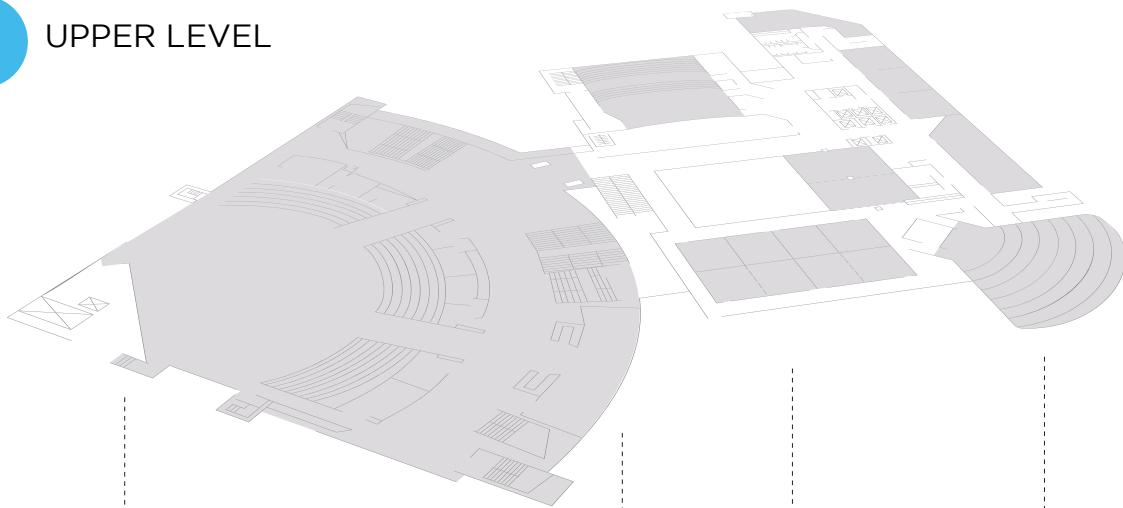

2 LOBBY LEVEL

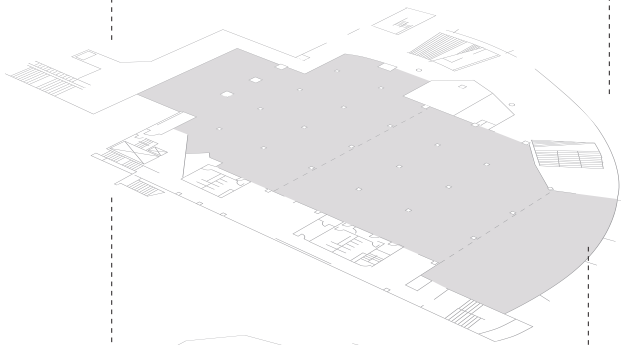

3 LOWER LEVEL

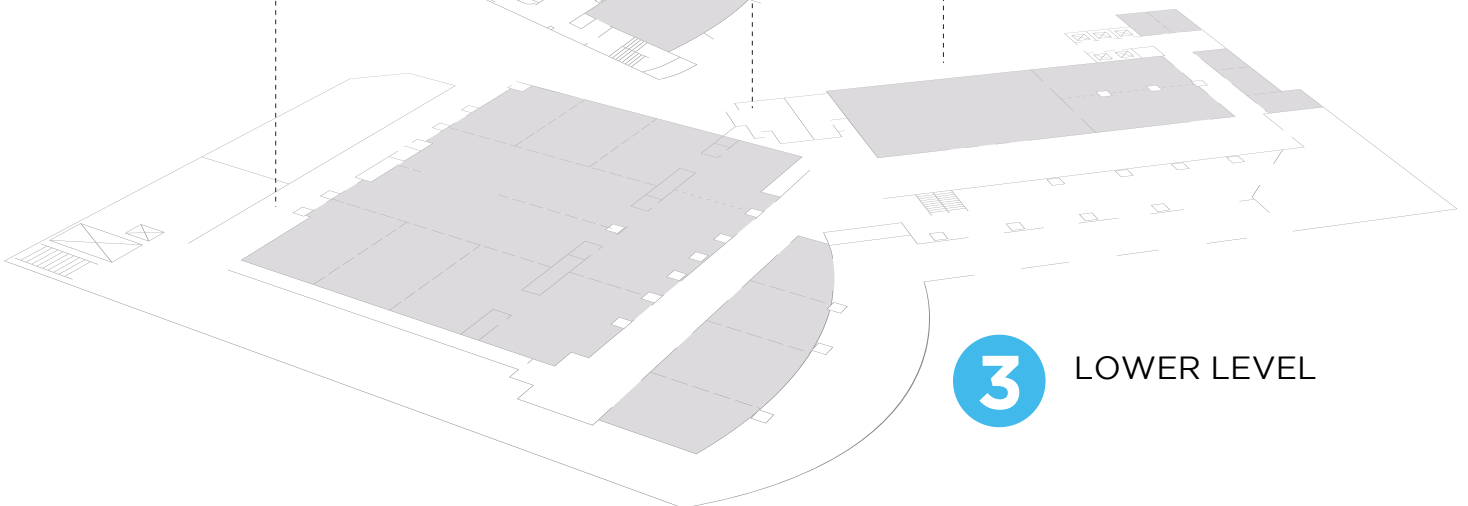

Aesthetic Congress Communications

THE INTERNATIONAL CONGRESS OF ESTHETICS AND SPA | MIAMI, FL

Hyatt Regency / James L. Knight Center | Nov 6 & 7, 2016

1

UPPER LEVEL FLOOR PLAN

■ = **BOOTH**

■ = **PRODUCT FOCUSED TRAINING**

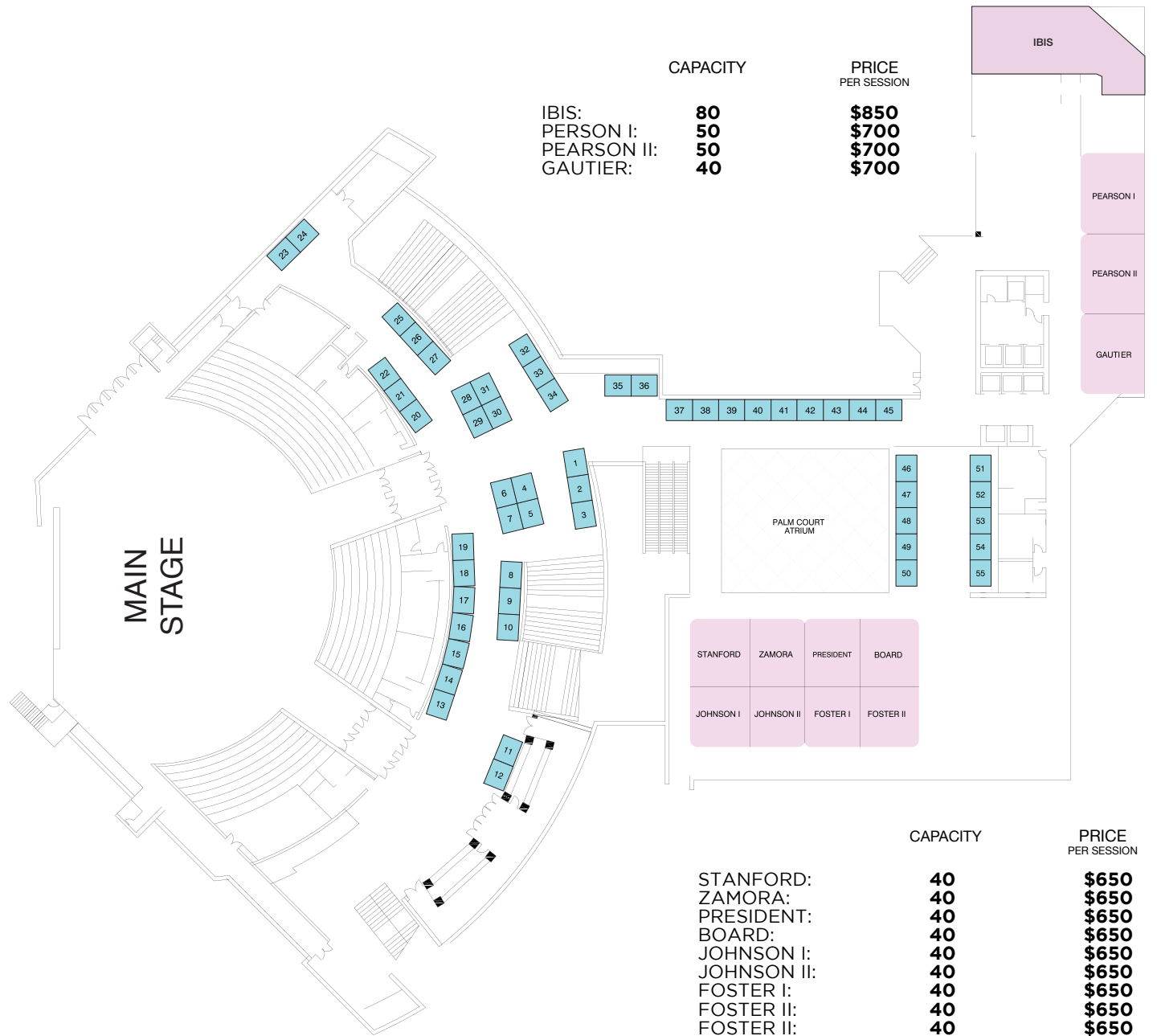

All booths are 8' X 10' and include:

- Standard 8' backwall
- 3' side-draped walls,
- Booth identification sign
- Two chairs
- One 6' draped table
- One wastebasket
- Security service
- Exhibitor service manual
- Free listing in the official show flyer if contract received before 6/27/2016
- Free listing in the official show program if contract received before 7/25/2016
- Free listing and link on the congress' web site
- Free listing in show's wayfinding signage

Price per Booth:	
On or before Feb 15, 2016	\$2400.00
After Feb 15, 2016	\$2600.00

Aesthetic Congress Communications

THE INTERNATIONAL CONGRESS OF ESTHETICS AND SPA | MIAMI, FL

Hyatt Regency / James L. Knight Center | Nov 6 & 7, 2016

2

LOBBY LEVEL FLOOR PLAN

= BOOTH



All booths are 8' X 10' and include:

- Standard 8' backwall
- 3' side-draped walls,
- Booth identification sign
- Two chairs
- One 6' draped table
- One wastebasket
- Security service
- Exhibitor service manual
- Free listing in the official show flyer if contract received before 6/27/2016
- Free listing in the official show program if contract received before 7/25/ 2016
- Free listing and link on the congress' web site
- Free listing in show's wayfinding signage

Price per Booth:	
On or before Feb 15, 2016	\$2400.00
After Feb 15, 2016	\$2600.00

Aesthetic Congress Communications

THE INTERNATIONAL CONGRESS OF ESTHETICS AND SPA | MIAMI, FL

Hyatt Regency / James L. Knight Center | Nov 6 & 7, 2016

3

LOWER LEVEL FLOOR PLAN

= **BOOTH**

= **PRODUCT FOCUSED TRAINING**

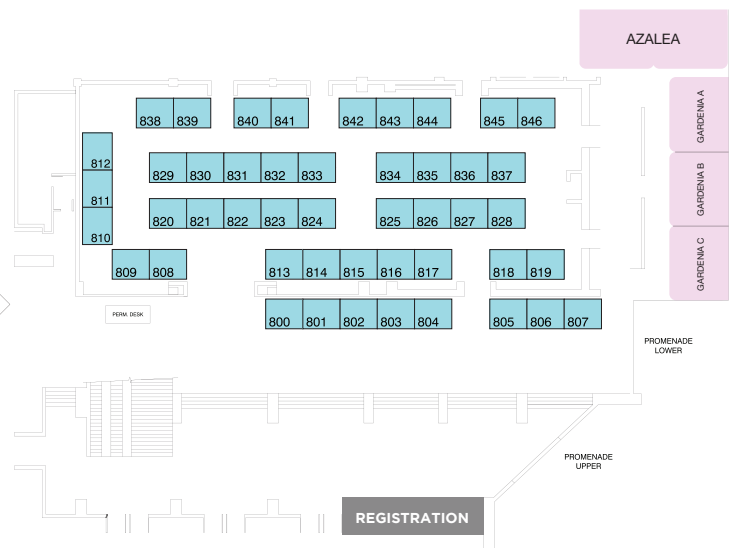
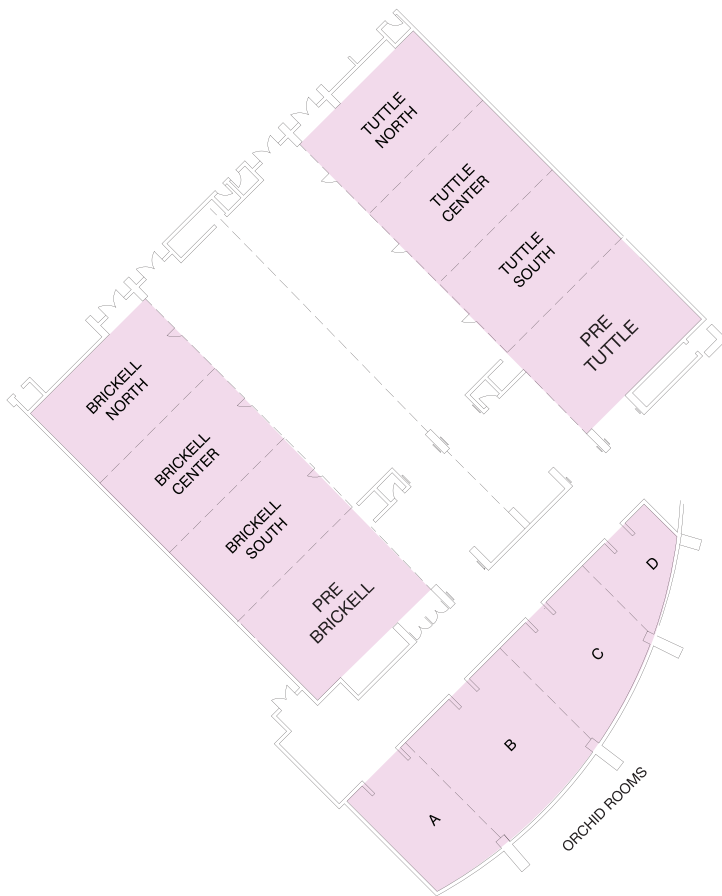

	CAPACITY	PRICE PER SESSION
ORCHID ROOM A:	20	\$550
ORCHID ROOM B:	40	\$650
ORCHID ROOM C:	80	\$850
ORCHID ROOM D:	40	\$650
PRE-BRICKELL	80	\$850
BRICKELL NORTH:	80	\$850
BRICKELL CENTER:	70	\$800
BRICKELL SOUTH:	80	\$850
PRE-TUTTLE	80	\$850
TUTTLE NORTH:	80	\$850
TUTTLE CENTER:	70	\$800
TUTTLE SOUTH:	80	\$850
AZALEA:	40	\$650
GARDENIA A:	25	\$600
GARDENIA B:	25	\$600
GARDENIA C:	35	\$650

All booths are 8' X 10' and include:

- Standard 8' backwall
- 3' side-draped walls,
- Booth identification sign
- Two chairs
- One 6' draped table
- One wastebasket
- Security service
- Exhibitor service manual
- Free listing in the official show flyer if contract received before 6/27/2016
- Free listing in the official show program if contract received before 7/25/ 2016
- Free listing and link on the congress' web site
- Free listing in show's wayfinding signage

Price per Booth:	
On or before Feb 15, 2016	\$2400.00
After Feb 15, 2016	\$2600.00